

## LANCE SCHIUMA A MEDIA ESPANSIONE Mod. FI – LME MEDIUM EXPANSION FOAM MAKERS Mod. FI – LME



### Caratteristiche Tecniche

- Resa schiuma: 1/60 con schiumogeno sintetico per alta e media espansione
- Tronchetto porta ugello ed ugello in inox
- Reti interne d'omologazione miscela inox
- Corpo lancia in inox
- Connessione: Flangiata, scanalata, filettata

### Technical Characteristics

- Foam production: 1/60 with syntetic foam compound suitable for high and medium expansion
- Pipe and nozzle in inox
- Internal homogenization net are made in inox
- Body foam maker are made in inox
- Connection: Flanged, grooved, threaded

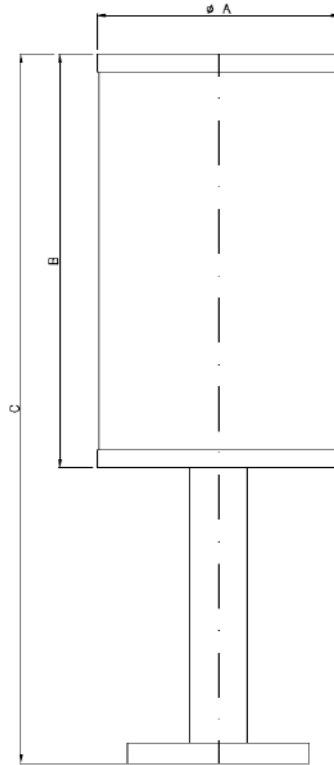

<b>MODELLO</b>	<b>PORTATA A 5 BAR</b>	<b>A</b>	<b>B</b>	<b>C</b>	<b>PESO KG.</b>
<b>MODEL</b>	<b>CAPACITY AT 5 BAR</b>	<b>mm</b>	<b>mm</b>	<b>mm</b>	<b>WEIGHT KG.</b>
FI-LME 2-4	200 - 400 lt/min	204	350	600	6
FI-LME 5-8	500 - 800 lt/min	304	500	715	10
FI-LME 8-18	800 - 1800 lt/min	400	885	1100	13